



**LIFEPROOF®**

LET'S GO!

**! READ BEFORE !  
INSTALLATION !**



LIFEPROOF® nüüd  
CASE FOR iPad

INSTALLATION INSTRUCTIONS

# LET'S GO!

LifeProof® gives you the freedom to make your iPad your constant companion — to make sure that you're ready to go, follow these steps

## FIRST TIME INSTALLATION

Follow the procedures on the inside of this brochure to make sure your LifeProof® nüüd iPad case is ready to go with you wherever you want to go and do whatever you want to do.

**IMPORTANT: PRIOR TO WATER EXPOSURE THE FOLLOWING PROCEDURE MUST BE ADHERED TO**

### CHECK O-RINGS

### WATER TEST

### iPAD INSTALLATION

## BEFORE YOU DIVE IN

You're probably really excited about all the new freedoms LifeProof® now brings you, but before you engage in any activities make sure you follow these common-sense rules:

- ✓ **FOLLOW THE INSTRUCTIONS**  
Study instructions showing correct installation and use
- ✓ **WATER TEST**  
Water test case prior to installing iPad
- ✓ **INSTALL CORRECTLY**  
Ensure your case is correctly installed
- ✓ **MAKE SURE IT'S ALL SEALED**  
Ensure all ports and seams are closed tightly
- ✓ **BACK-UP YOUR DATA REGULARLY**  
If you are going to engage in activities where there may be potential for damage to the device, ensure you have backed up your data.
- ✓ **BE SENSIBLE**  
Your LifeProof® nüüd iPad case is a precision piece of equipment, it is sleek, it is tough, but it's not indestructible. Use it sensibly and with consideration.

## EVERYDAY CARE CHECKLIST

Follow this checklist to make sure your iPad is protected by your LifeProof® nüüd iPad case

- ✓ **KEEP SEALS CLEAN**  
Always ensure all seals around the charge port door and headphone cover and o-ring are free of dust, fibers and debris before closing case
- ✓ **RINSE WITH FRESH WATER AFTER USE**  
Rinse case thoroughly with fresh water after exposure to chemicals including soap, detergents, and chlorine
- ✓ **REGULAR WATER TESTS**  
Perform water test without iPad, using clear test unit, at regular intervals and after major impacts
- ✓ **CHECK SEALS AFTER MAJOR IMPACTS**  
After major drops or impacts inspect case for any damage and ensure all seams are closed, see checklist below.

IF A MAJOR IMPACT OCCURS, FOLLOW THESE STEPS:

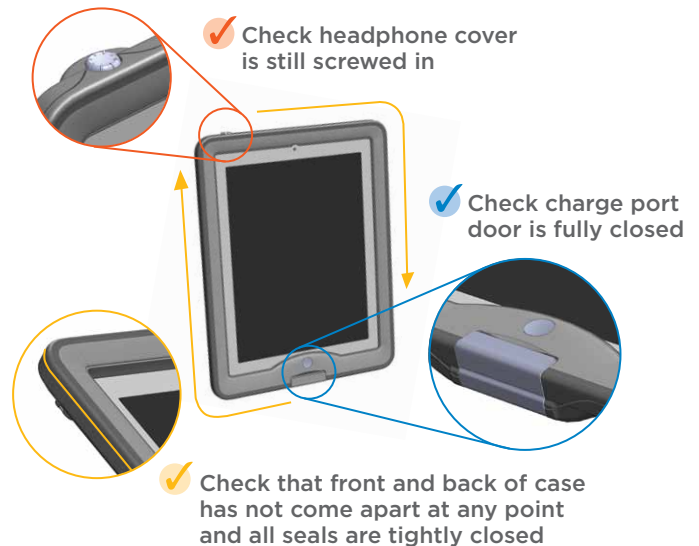

**AFTER MAJOR IMPACTS: IT IS HIGHLY RECOMMENDED THE FIRST TIME INSTALLATION PROCEDURE IS PERFORMED TO CHECK THE INTEGRITY OF THE CASE BEFORE EXPOSING TO WATER**

FOR INSTRUCTIONS, WARRANTY REGISTRATION, TIPS AND HELPFUL VIDEOS VISIT:  
[www.lifeproof.com/support](http://www.lifeproof.com/support)

### ⓘ IMPORTANT ⓘ

Have fun and live free, but remember if an activity could hurt you, it could also hurt your device. This case is a precision piece of equipment, however it is not indestructible and should be used with consideration. Case or device may be damaged by drops from less than tested height — particularly on non-smooth surfaces. We do not warranty that this case will protect your device in all circumstances — user exposes their device to hazards at own risk. User must follow all installation, maintenance, and operating instructions carefully for water, dust, and shock protection. This case is not a substitute for regular back-ups or device insurance.

DO NOT USE A DAMAGED CASE FOR PROTECTION

# FREEDOM STARTS HERE

Follow these steps to make sure you are ready to experience new freedoms with your iPad

## CHECK O-RINGS

- ✓ Check that the o-rings are installed correctly (see diagrams below).
- ✓ Make sure they are free of dust, dirt, hair and other debris.

If the o-rings are not clean, remove them and rinse in warm water, then give them a quick shake to remove excess water before immediately reinstalling

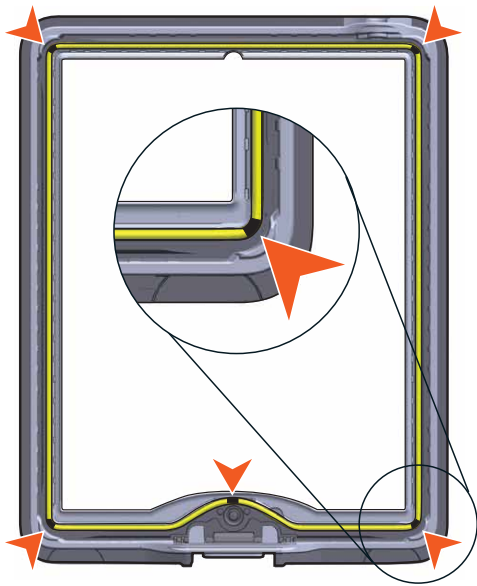

### FRONT SECTION

Make sure o-ring (shown in yellow) is firmly seated in the groove and the black marks on the o-ring are positioned as indicated

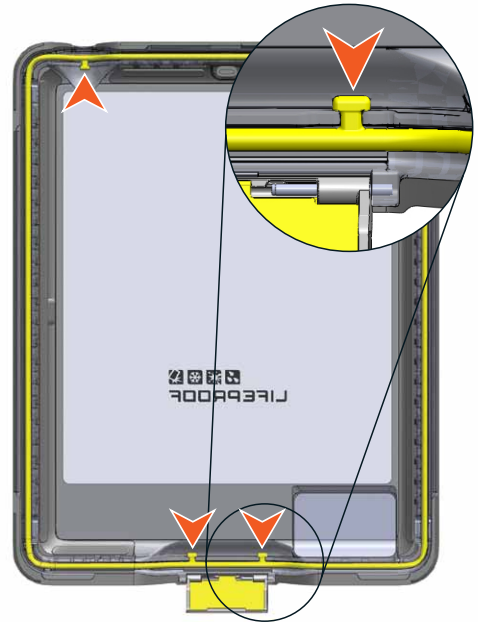

### BACK SECTION

Make sure o-ring (shown in yellow) is firmly seated in the groove and the three 'T' shapes on the o-ring are positioned as indicated

# WATER TEST

Let's start by checking that your LifeProof case is good-to-go by doing the water test. This test checks that all the seals and case are working properly.

- 1** PLACE CLEAR IPAD TEST UNIT INTO THE REAR CASE SECTION

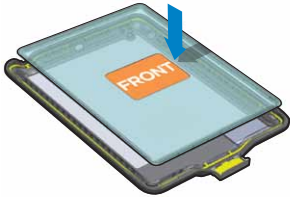

- 2** SLIDE THE CASE FRONT ON AT AN ANGLE, HOOKING THE BASE ON FIRST

Slide hooks are highlighted in **red**



- 3** FIRMLY SNAP FRONT AND BACK OF CASE TOGETHER

Start at bottom and work around case to top.

Once complete, inspect all edges to make sure the case is fully closed.

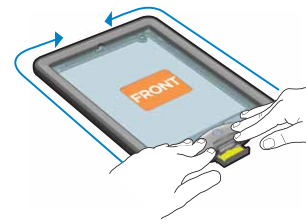

- 4** CLOSE ALL THE SEALS

Screw in the plug hole cover until snug (**A**) and snap shut the charge port door (**B**)



- 5** SUBMERGE UNDER 12 IN / 30 CM OF WATER FOR 3 MINUTES

Hold underwater or place a heavy object on case to keep it submerged

If there is a constant stream of bubbles, check for gaps in surrounding edge, or o-ring position, dry out case interior and repeat test.

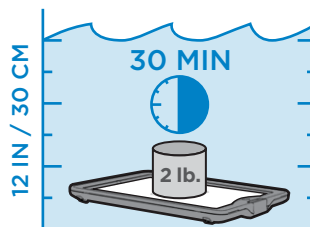

- 6** PULL CASE OUT OF WATER AND SHAKE MOST OF WATER OFF, USE A TOWEL TO DRY THOROUGHLY

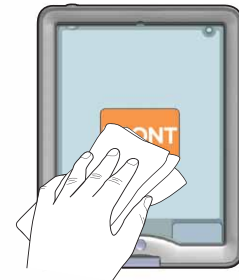

- 7** CHECK TO ENSURE NO WATER INSIDE BY LOOKING THROUGH THE TRANSPARENT SECTIONS

If there is water inside, check for gaps in surrounding edge, or o-ring position, dry out case interior and repeat test.



- 8** OPEN CASE BY FIRST OPENING CHARGE PORT DOOR, THEN INSERTING A COIN INTO GAPS AT BOTTOM AND TWISTING

See more details below in the *REMOVAL* section

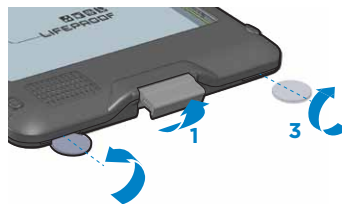

- 9** SEPARATE FRONT FROM BACK CASE, REMOVE TEST UNIT AND CHECK INTERIOR IS DRY

If there is water inside, check o-ring position, dry out case interior and repeat test.

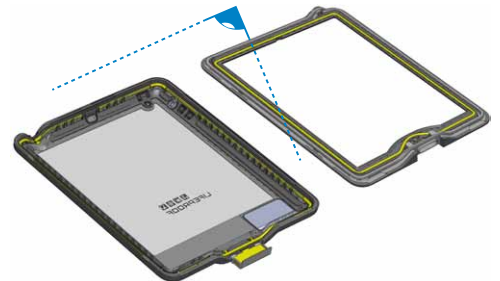

WATER TEST  
COMPLETE

IF CASE INTERIOR IS DRY, THE CASE PASSES THE WATER TEST: **GO ON TO IPAD INSTALLATION**

PROBLEMS WITH THE WATER TEST? VISIT: [www.lifeproof.com/support](http://www.lifeproof.com/support)

# iPAD INSTALLATION

Now you're ready for the really exciting stuff: installing your pride and joy ... and iPad.

## ⚠ IMPORTANT ⚠

If you have a screen protector on your iPad it is recommended you remove it before installation as it may cause leaks.

- 1** PLACE IPAD INTO THE REAR CASE SECTION

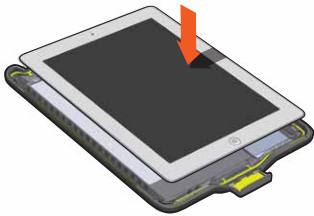

- 2** SLIDE THE CASE FRONT ON AT AN ANGLE, HOOKING THE BASE ON FIRST

Slide hooks are highlighted in **red**

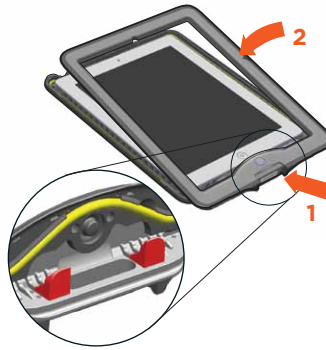

- 3** FIRMLY SNAP FRONT AND BACK OF CASE TOGETHER

Start at bottom and work around case to top. Once complete, inspect all edges to make sure the case is fully closed.

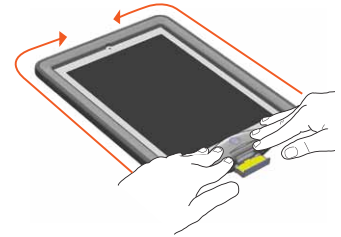

- 4** CLOSE ALL THE SEALS

Screw in the plug hole cover until snug (**A**) and snap shut the charge port door (**B**)

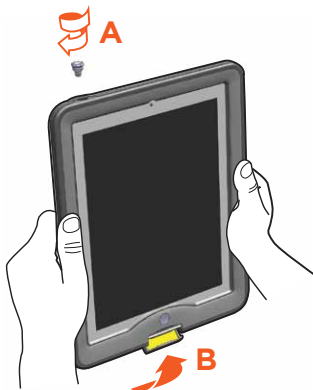

- 5** MAKE SURE ALL THE FUNCTIONS WORK

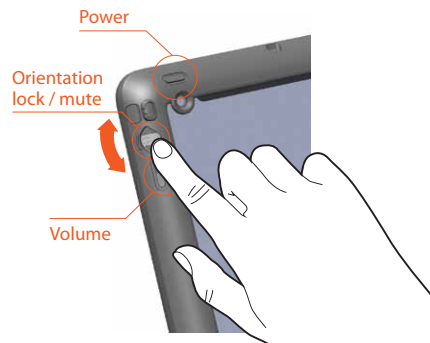

- 6** NOW, YOU'RE READY FOR FREEDOM



BEFORE ENGAGING IN ANY ACTIVITIES, IT IS RECOMMENDED YOU READ THE *BEFORE YOU DIVE IN* SECTION

# LET'S GO!

## REMOVAL

- 1** OPEN CASE BY FIRST OPENING CHARGE PORT DOOR, THEN INSERTING A COIN INTO GAPS AT BOTTOM AND TWISTING

Twisting in a circular motion with coin works best



- 2** LIFT THE BACK OF THE CASE AND GENTLY WORK THE BACK OFF USING A ROCKING MOTION

Do not bend the case back and remove in a single motion



- 3** GENTLY LIFT THE IPAD OUT AT SLIGHT DIAGONAL ANGLE

This ensures the slide hooks are cleared when iPad is removed



ALL DONE

## HEADPHONE ADAPTER USE

Your LifeProof® nüüd iPad case comes with a headphone adapter that allows you to use headphones in wet, dusty, or icy environments all while keeping your iPad safe and sound.



- 1** REMOVE PLUG HOLE COVER



- 2** PUT PLUG HOLE COVER INTO KEEPER AND SCREW IN HEADPHONE ADAPTER

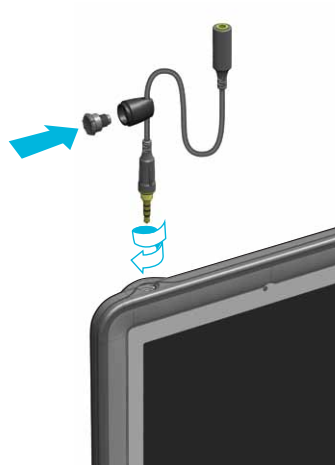

- 3** PLUG IN YOUR HEADPHONES





**LIFEPROOF**  
LET'S GO!

**HOW WILL YOU USE YOUR LIFEPROOF?**

**ON THE JOB**



construction sites



on the road



all weather conditions

**IN ACTION**



adventure and the outdoors



when navigating



on the water

**AT HOME**



in and around the pool



with the kids



cooking and mess

**AT SCHOOL**



go-anywhere textbook



science and discovery



fun and sports

**WATER PROOF**

Fully submerge underwater down to 6.6 ft

**DIRT PROOF**

Totally sealed from minute dust particles

**SNOW PROOF**

Complete protection keeps ice and snow out

**SHOCK PROOF**

Designed to military drop survivability specifications



**CONNECT WITH LIFEPROOF**

Follow us and share your LifeProof® stories using #LifeProof here:



[www.lifeproof.com](http://www.lifeproof.com)

Join LifeProof® 360+5 to get the most from your LifeProof® case:



[lifeproof.com/support](http://lifeproof.com/support)